

NATIONAL GEODETIC SURVEY VISIBILITY OBSTRUCTION DIAGRAM

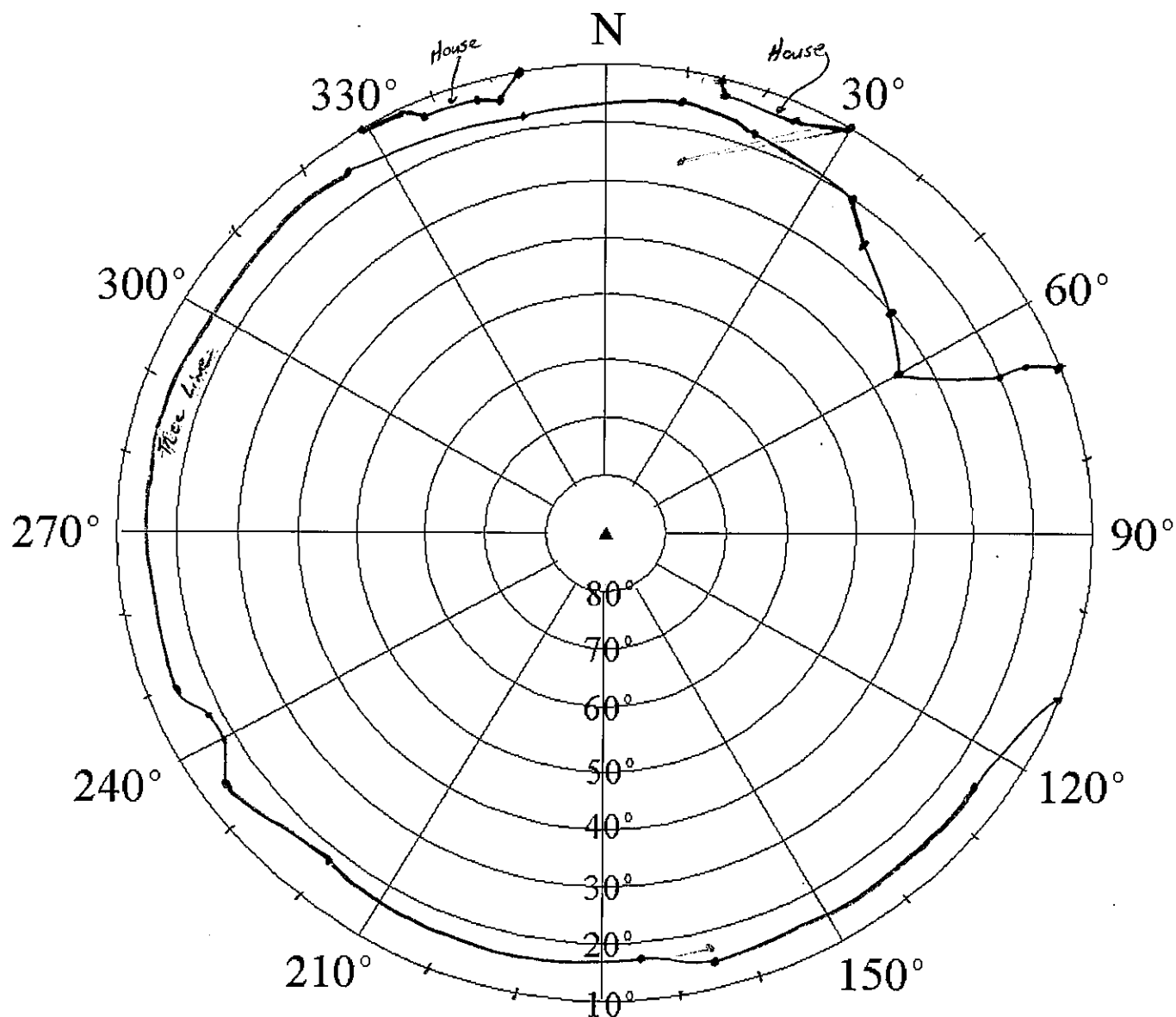

INSTRUCTIONS:

Identify obstructions by azimuth (magnetic) and elevation angle (above horizon) as seen from station mark. Indicate distance and direction to nearby structures and reflective surfaces (potential multipath sources).

4-char ID: BETH Designation: BETHEL SPRINGS
 PID: _____ Location: 204 Bethel Springs Dr, North East, MD 21901 (median)
 County: CECIL Reconnaissance By: RM RC
 Height above mark, meters: 2 Agency/Company: G. W. Stephens, Jr. and Assoc.
 Phone: (_____) (410) 297-2340 Date: 1-9-09

Check if no obstructions above 10 degrees ☐